

## G 4.1 The Maltese Islands



### G4.1.1

Let's learn about maps and plans.

Let's learn how to make the plan of a class, a school and a square.

Research by Edith Vella, MV Galea and Marlene Vella - St Nicholas College Rabat

### A. Read about Plans.

Plans are designed by **architects**. Architects design houses, schools, palaces, gardens, roads, tunnels or other buildings.

The design of the plan shows us the size and the internal and external appearance of the building.

The plan therefore shows us *the layout* of the building designed by the architect. It shows us the location of the rooms, yards, doors, windows and other details.

Other professionals, like engineers also need to draw plans during their work. These might be plans of machines and other useful items.

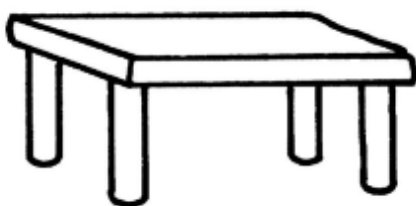

This is the picture of a table.



If you were to climb up a ladder and look down, the table would look like this. You wouldn't be able to see the legs. This picture is called a **PLAN**.

## B. The Plan of a Class

The following is the plan of a class. This plan gives us a lot of information. It shows us the size of the class, the location of the desks and chairs, the computers, the whiteboard and other objects necessary for learning.

It is important for the class to be **large**, **airy** and **well-lit**.

The symbols on the left represent the items which can be found in the classroom.

### A Classroom Plan

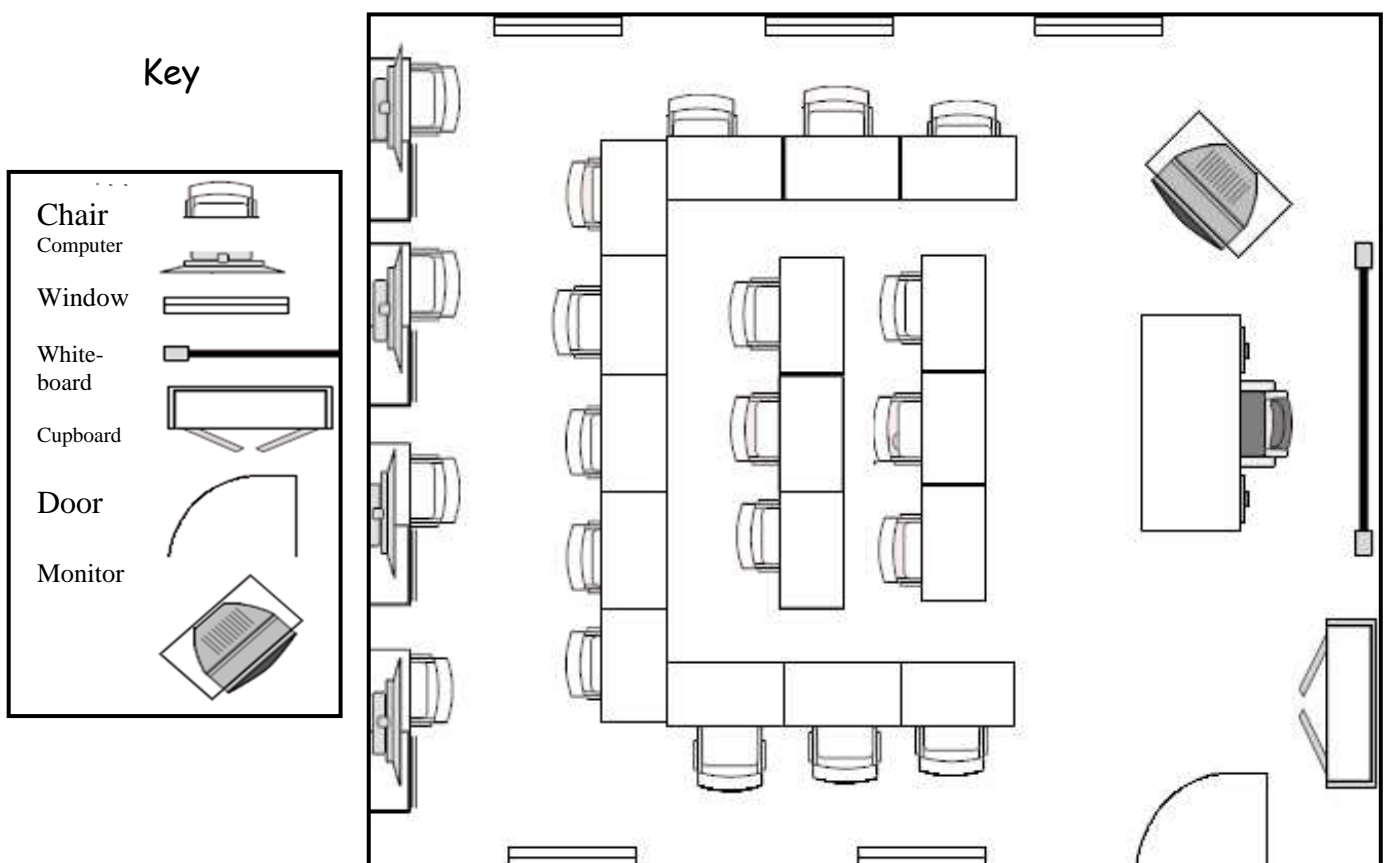

### C. The Plan of a School

By looking at this plan we can see the layout of the ground floor of this school. It is easy to locate the Headmaster's and assistant heads' office, the classrooms, the yard, the toilets, the corridors and other places.

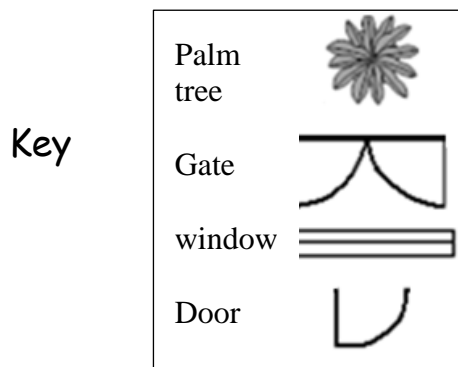
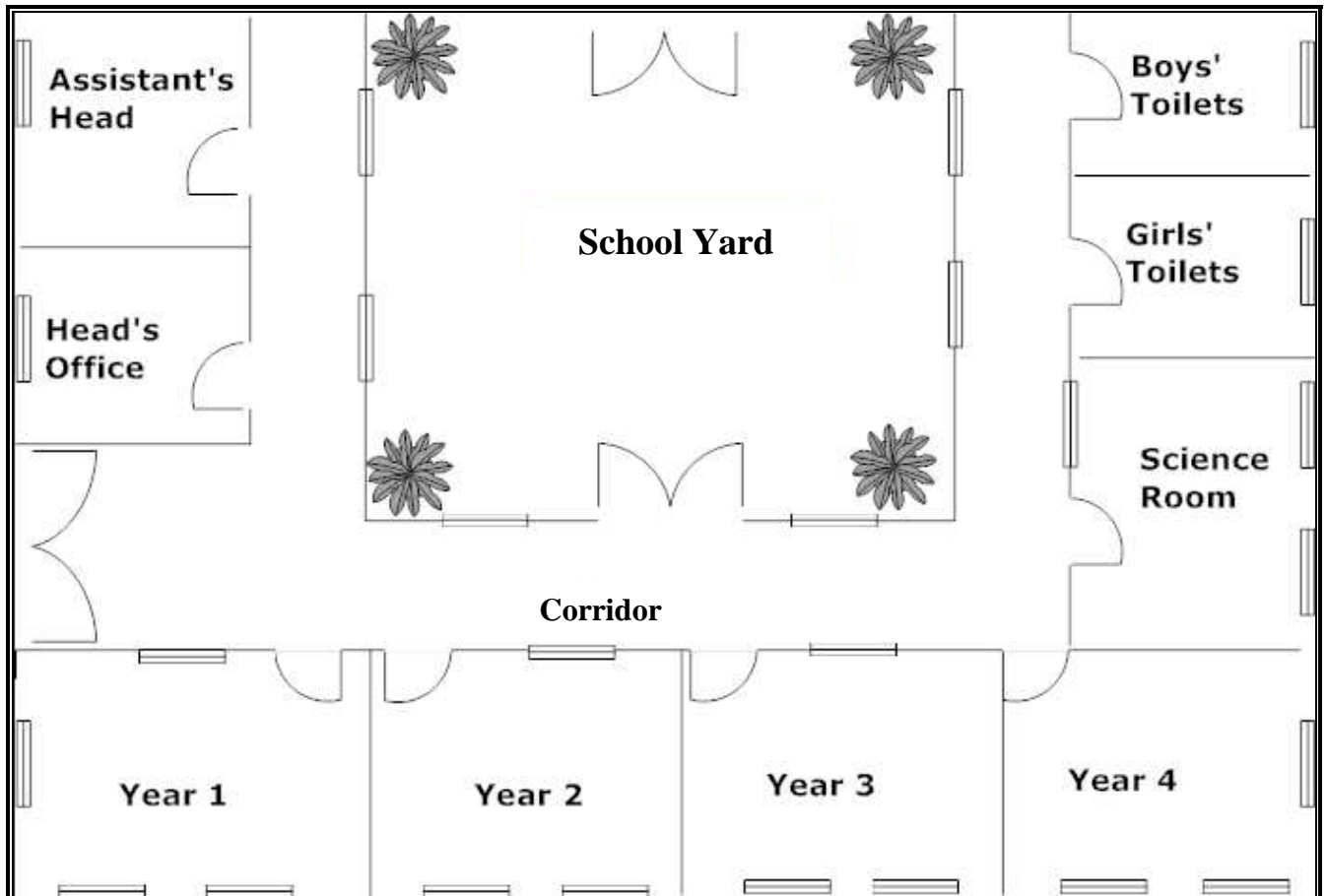

The picture on the left shows us some more symbols.

## D. The Plan of a Village

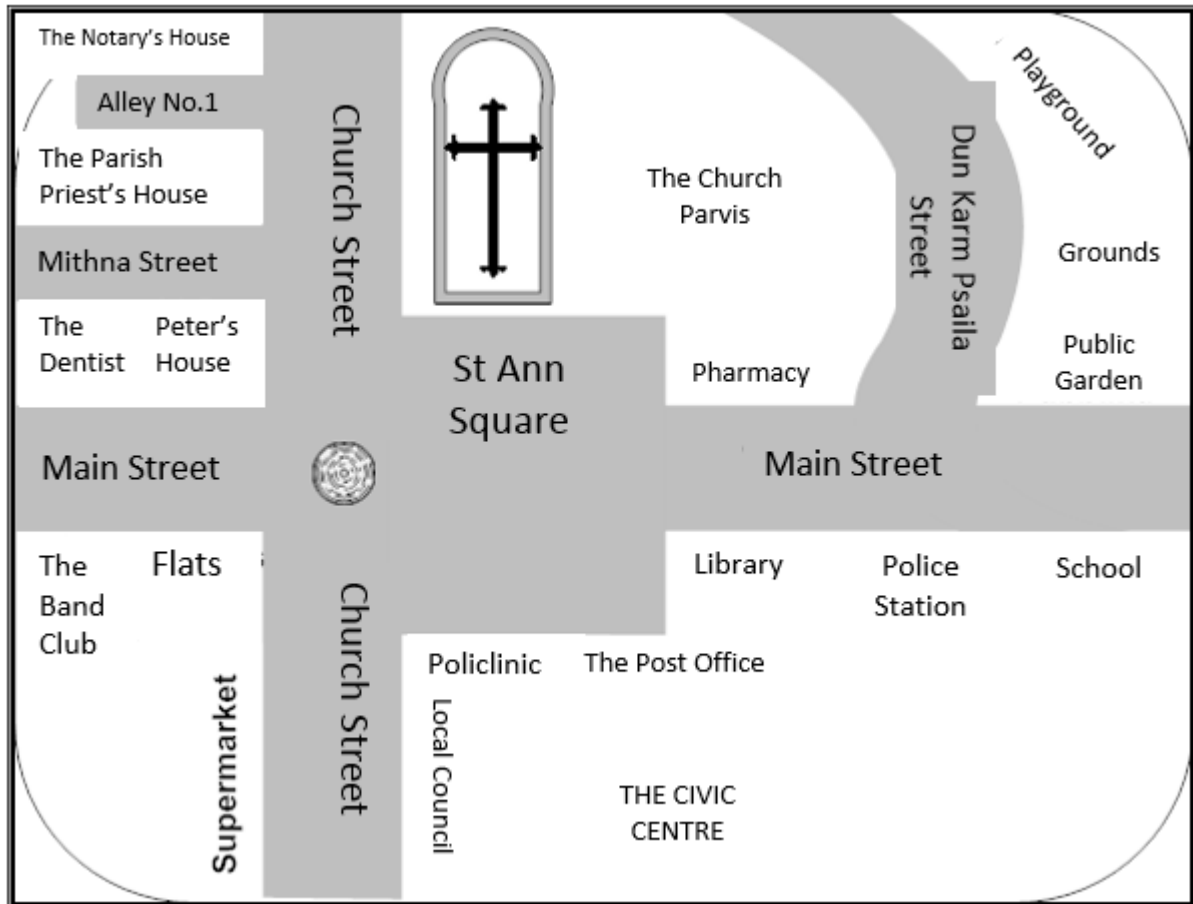

In the **centre** of most towns and villages we find a **big church**.

**The main roads** surround the church. In these roads we find important buildings such as:

The Police Station

The Civic Centre

Shops

Services: dentist, notary, doctor.....

Houses

Public Gardens

Playground

School.

The **roads** all have a **name**. These help people find the places they want to go to which makes life easier for everyone. The picture below shows an aerial view of Rabat centre, Malta.



The picture below shows the plan of the same Rabat centre. As one can see this is much easier to follow.

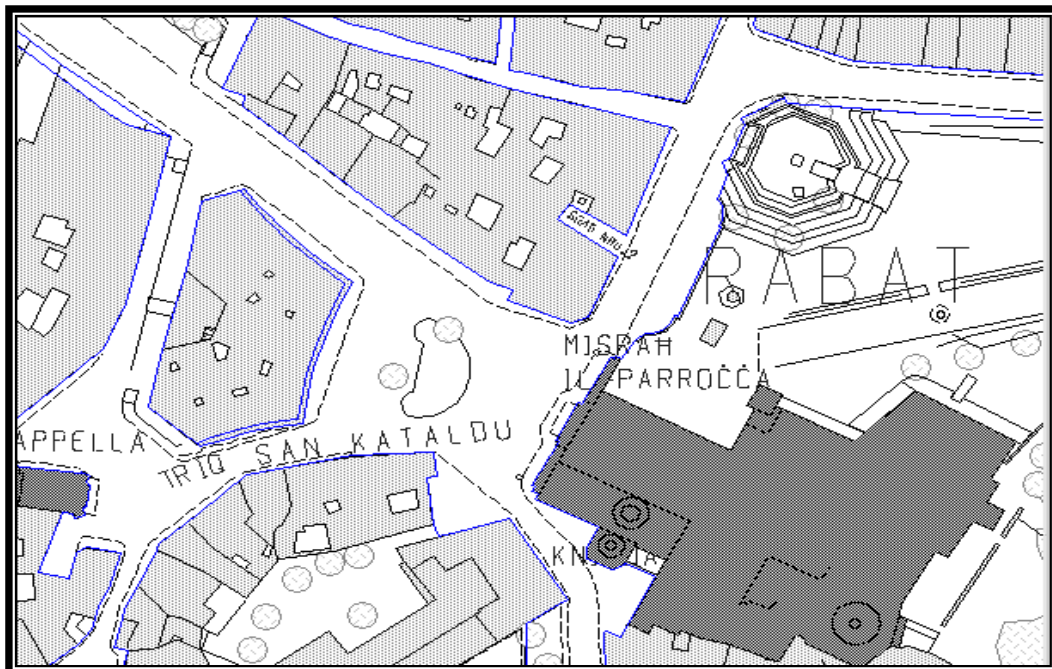

**D. Work out the following.**

a. Look at the plan of this car.

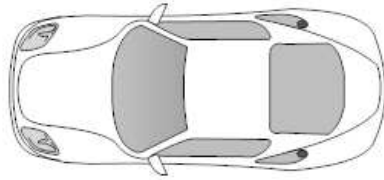

b. Now draw the plan of how you imagine a **carpet** and a **chair** would look like in the boxes below.

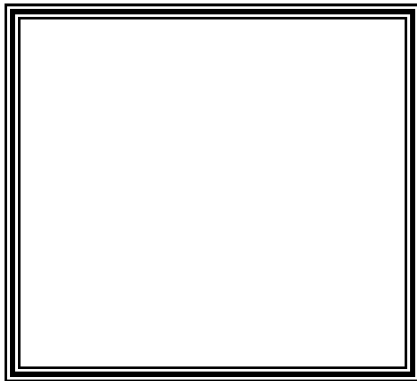

Plan of a carpet

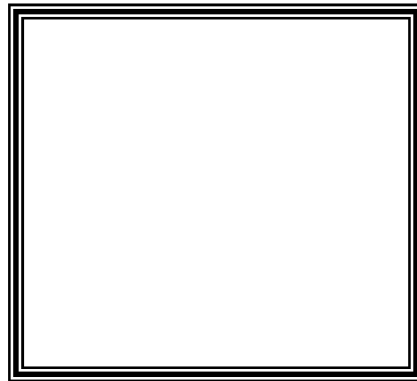

Plan of a chair

Imagine you have placed four tins of milk, one on each corner of a table. Now, in the box below, draw the table and tins as you imagine they would **appear from above**.

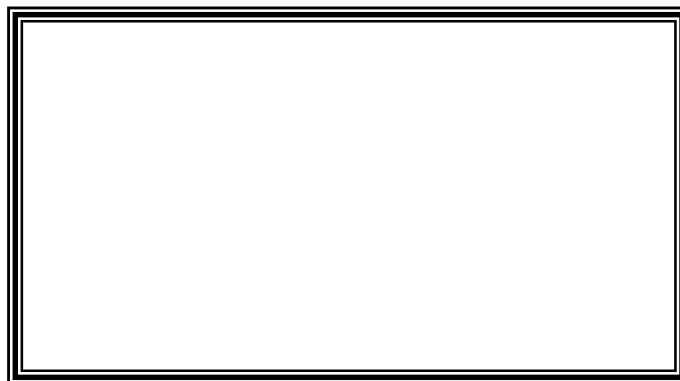

**E. Draw the plan of your bedroom.**

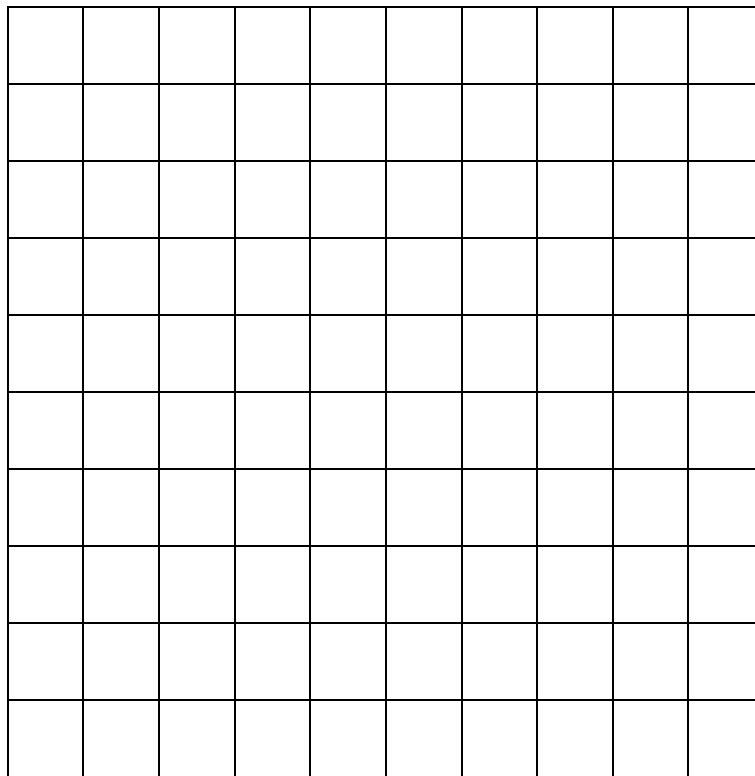

- ❖ First draw the design in pencil to make sure that everything fits in.
- ❖ You may use some of the symbols we've learnt so far.

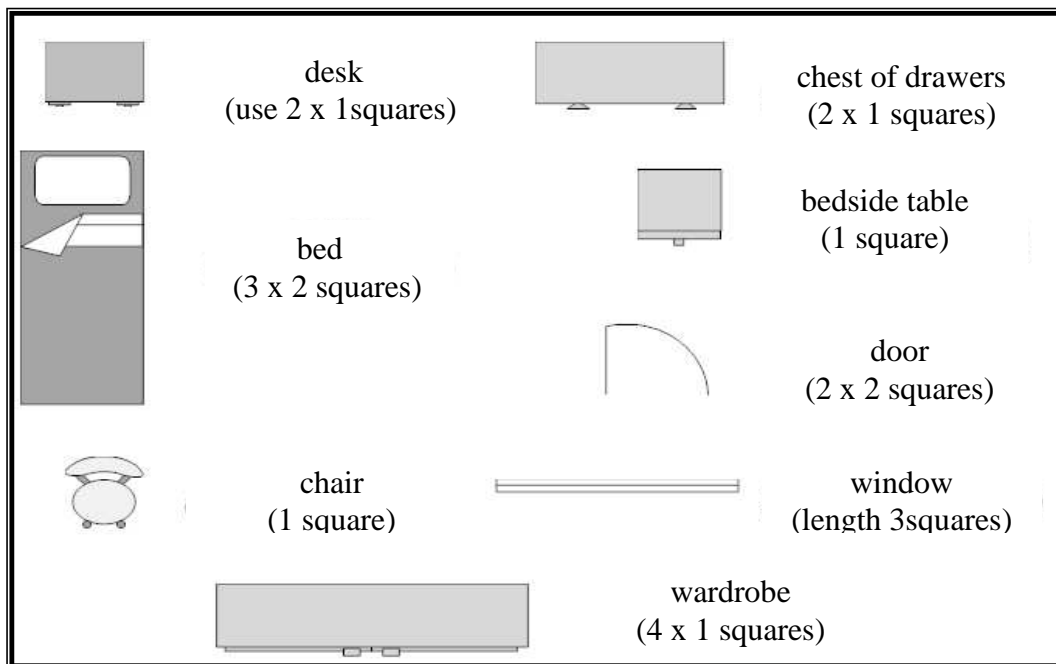

F. Look at this map and answer the following questions

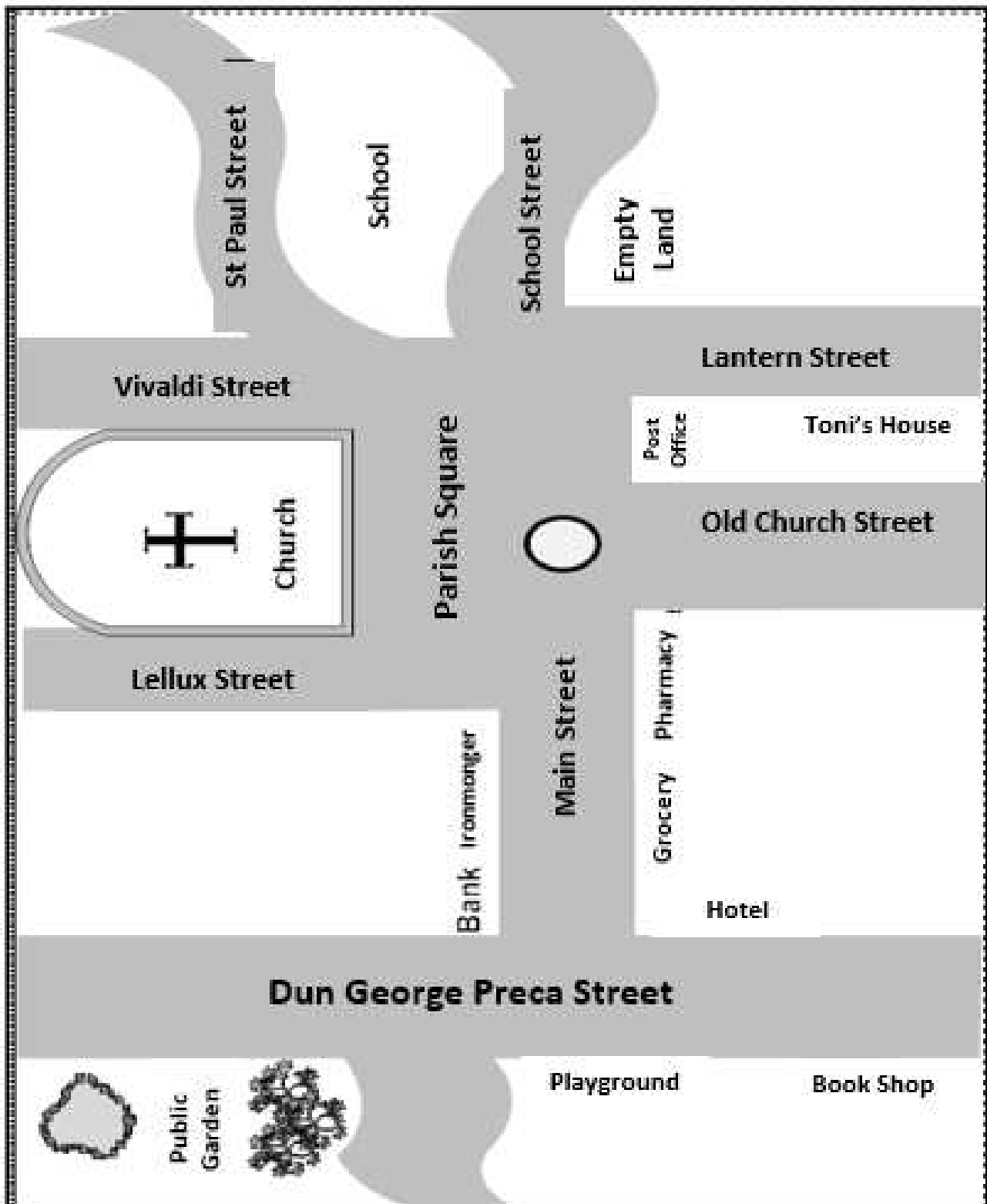

Answer according to what you can see in the map of the village.



1. The **village church** is in the \_\_\_\_\_.
2. The **road opposite the church** is called \_\_\_\_\_.
3. Toni likes to spend his **free time** in the \_\_\_\_\_.
4. To go to the **pharmacy** Toni has to walk along Lantern Street, then turn to the left and cross \_\_\_\_\_ Street.
5. The **hotel** is on the corner of \_\_\_\_\_ Street and \_\_\_\_\_ Street.
6. Toni's mother went shopping in two shops which are **opposite each other**.  
First she went to the \_\_\_\_\_ and then to the \_\_\_\_\_.
7. Mark **in red** the best route Toni can use to go from the church to the bookshop.
8. On the plan there is a piece of land marked as 'empty land'. This is opposite the school.  
What would you do with this piece of land, facing the school, if it were yours?  
\_\_\_\_\_  
\_\_\_\_\_
9. Where would you put Dun Karm's monument if you were asked to do so?  
Mark this place on the plan by drawing a **blue circle**.  
Beneath the circle write the word **Monument**.

## What is a Map?

Topic prepared by Marisa Pace - Maria Regina College - Gharghur

A map is a small picture giving us an aerial view of a country, town or village.

We use a map to find a town or village in a particular country. We use a map when we go abroad to see where we are.

Tourists use maps to travel from one country to another

- ❖ A tourist needs a map to find which road he has to take.
- ❖ To find a town or village in Malta I need a map of Malta.
- ❖ To find where Spain is I need a map of Europe.
- ❖ To find where any continent is I need a map of the world.

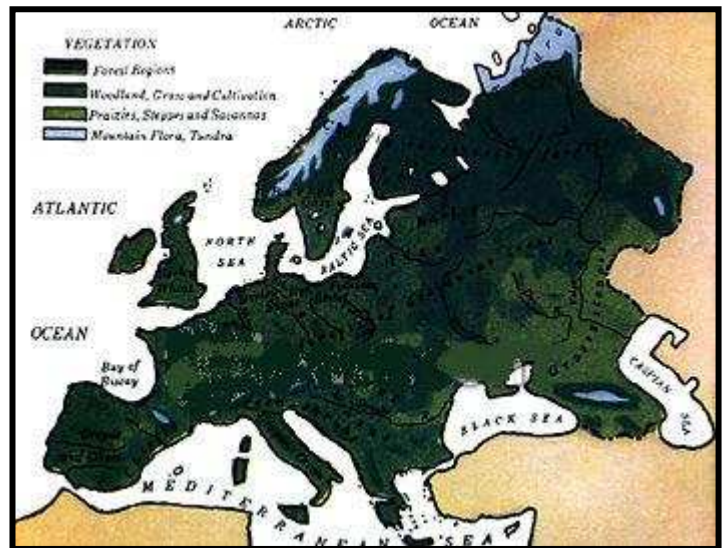

The Map of Europe



The Map of the World

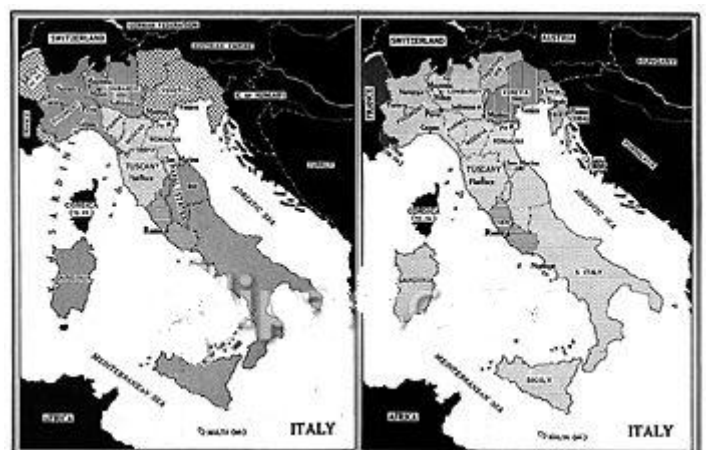

The Map of Italy